

SLOUGH MULTIFUEL EXTENSION PROJECT

Planning Inspectorate Ref: EN010129

The Slough Multifuel Extension Order

Land at 342 Edinburgh Avenue, Slough Trading Estate, Slough

**Document Ref: 7.7.14 Condition 21 – Temporary Construction
Compound – Construction Site Layout Temporary Illuminations**

The Planning Act 2008



Applicant: SSE Slough Multifuel Limited

May 2023 – Deadline 5

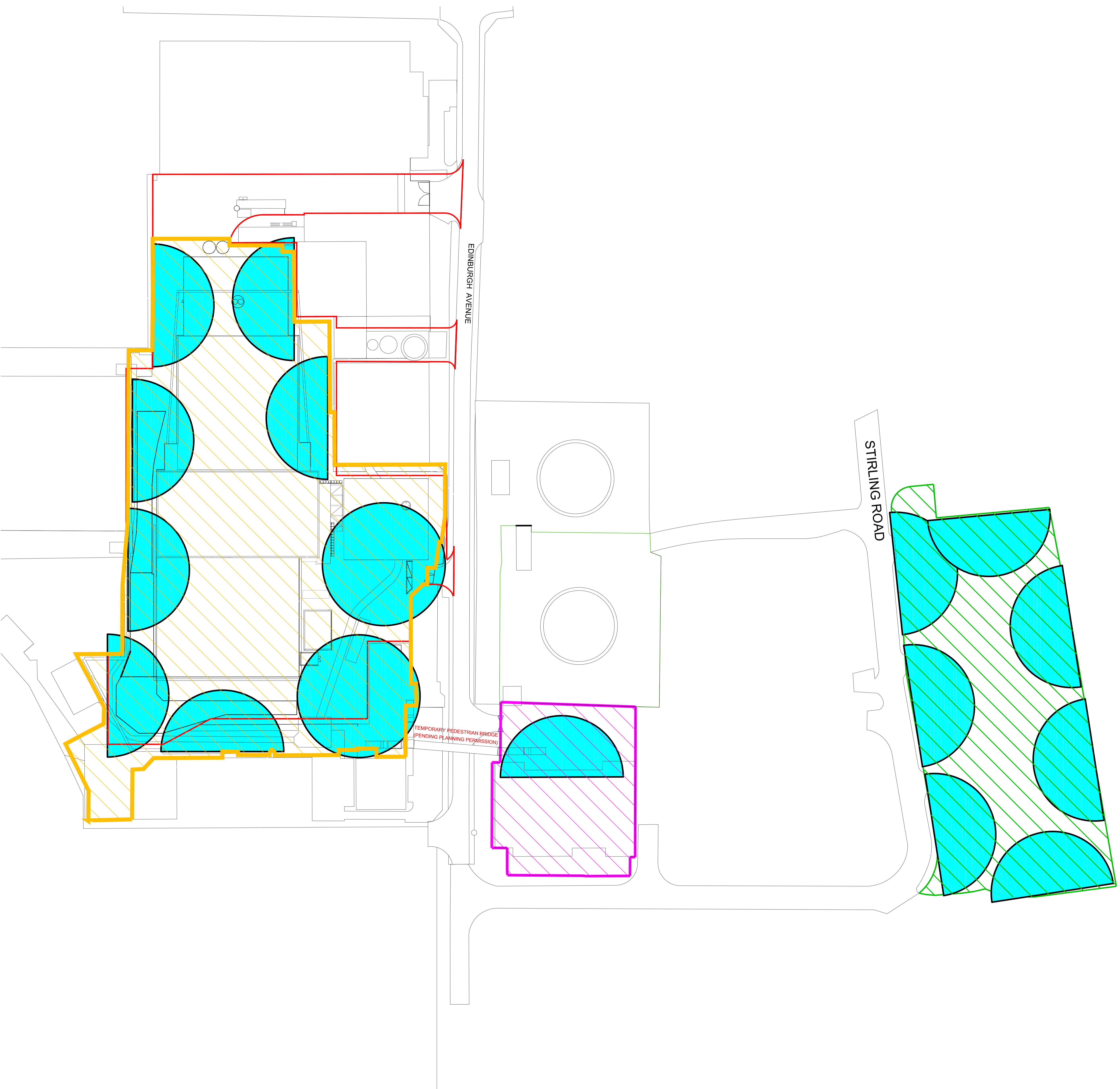
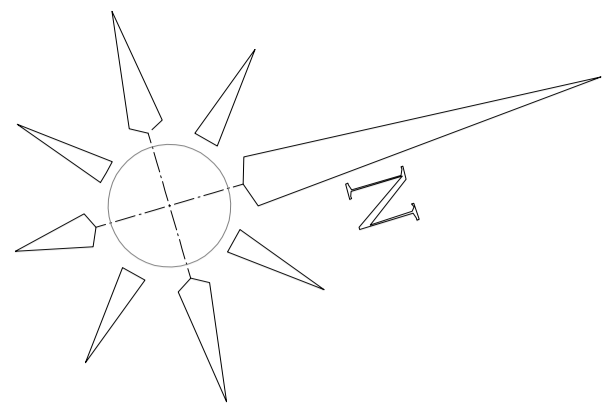

ORIENTATION

SCALE

KEYPLAN

NOTES AND SYMBOLS

- PLANNING BOUNDARY
- PRE-ASSEMBLY AREA / HEAVY ERECTION (50mm; max slope 3%)
- LAY DOWN AREA (250mm; max slope 3%)
- WELFARE & OFFICE AREA

Height of luminaires will be max. 15m and of LED Type

Lighting to be switched off when not required overnight

Luminaires to be positioned so that the extent of any light spill upwards or outside the site is minimised

Lighting is to be directed so that there is no potential for glare affecting adjacent road users

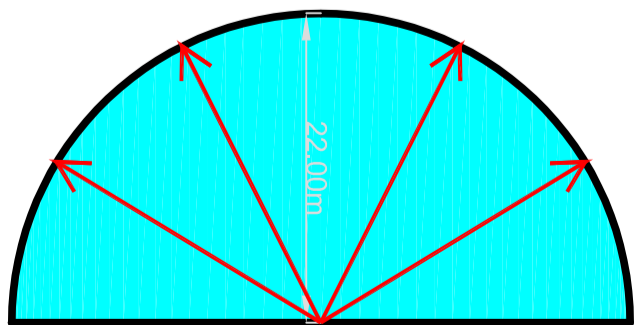

Arrow illustrates illumination pointing direction
Coloured area shows main illuminated area

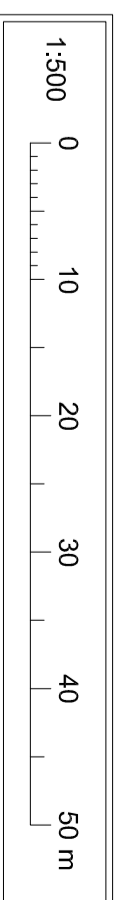

BS00 - Site Overall

NO.	DESCRIPTION	DATE	BY	CHKD BY	APPROVED BY
01	Issue for Construction	15/03/2024	MM	MM	MM
02	Revised	15/03/2024	MM	MM	MM

VE3238 Slough Multihall
CONSTRUCTION SITE LAYOUT
TEMPORARY ILLUMINATION
Hitachi Zosen
INOVA